

E 8

65

65

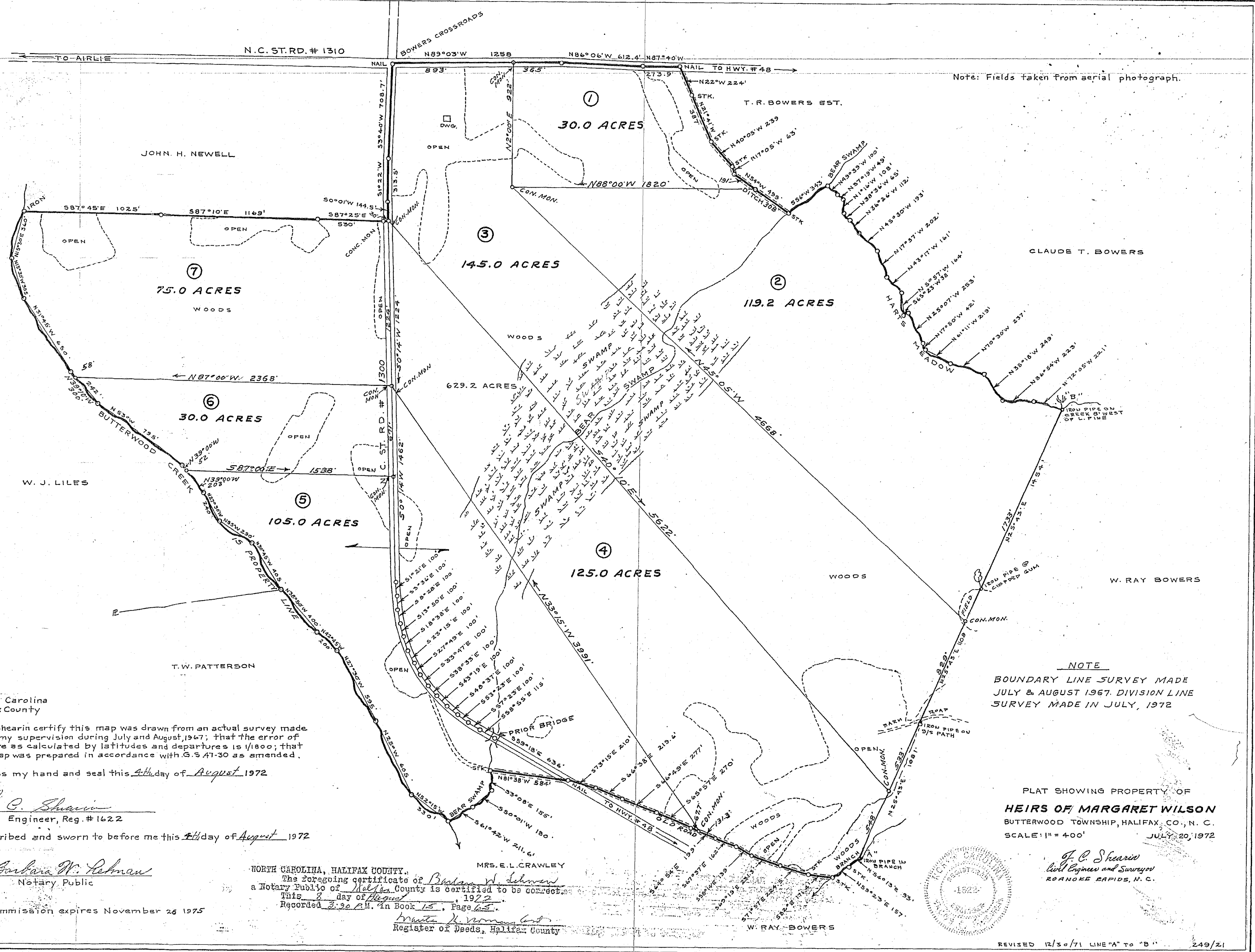

North Carolina
Halifax County

I, J.C. Shearin certify this map was drawn from an actual survey made under my supervision during July and August, 1972; that the error of closure as calculated by latitudes and departures is 1/1800; that this map was prepared in accordance with G.S. 41-30 as amended.

Witness my hand and seal this 4th day of August, 1972

J. C. Shearin
Civil Engineer, Reg. # 1622

Subscribed and sworn to before me this 4th day of August, 1972

Barbara W. Lehman
Notary Public

My commission expires November 26 1975

NORTH CAROLINA, HALIFAX COUNTY.

The foregoing certificate of *Barbara W. Lehman*
a Notary Public of *Halifax* County is certified to be correct.

This 8 day of August, 1972

Recorded 8:20 P.M. in Book 15, Page 63.

Walter D. ...
Register of Deeds, Halifax County

NOTE
BOUNDARY LINE SURVEY MADE
JULY & AUGUST 1967. DIVISION LINE
SURVEY MADE IN JULY, 1972

PLAT SHOWING PROPERTY OF
HEIRS OF MARGARET WILSON
BUTTERWOOD TOWNSHIP, HALIFAX CO., N. C.
SCALE: 1" = 400' JULY 20, 1972

J. C. Shearin
Civil Engineer and Surveyor
RANDOLPH RAPIDS, N. C.

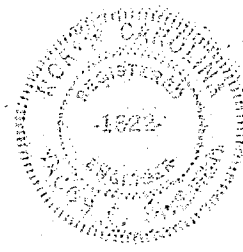

REVISED 12/30/71 LINE "A" TO "B" 249/21

15-65